

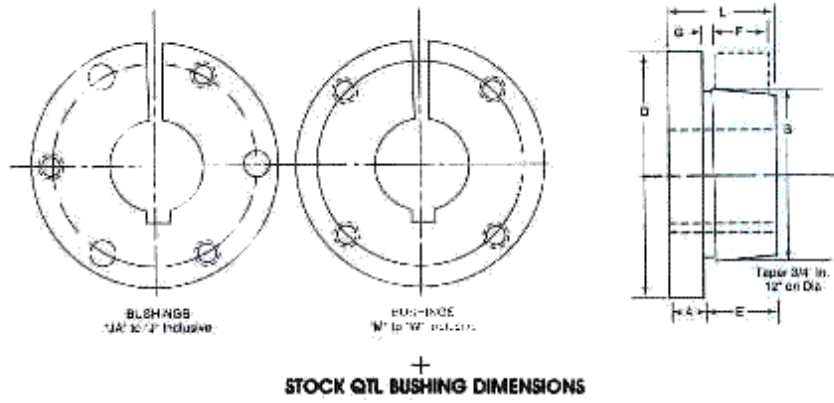

## QTL TAPER



The 'QTL' Bushing easily fits over the tapered hub and a tight press can be produced on the shaft by tightening capscrew .The bushing is easily removed from the hub by using the pull-up bolts as jack bushing in the holes tapped in the rim of bushing .All hubs 'JA' through 'J' are drilled for **RECERSE MOUNTING**.

BUSHING	DIMENSIONS(INCHES)								CAP SCREWS REQUIRED	STOCK BORE RANGE			AVERAGE WEIGHT (APPROX)
	A	B	D	E	*F	**G	L	BOLT CIRCLE		MINIMUM	MAXIMUM		
											STANDARD KEYWAY	SHALLOW KEYWAY	
JA	5/16	1.375	2	11/16	9/16	0.20	1	1.656	3-10 X1	3/8	1	13/16	0.9
SH	7/16	1.871	2 1/16	7/8	13/16	0.23	15/16	2 1/4	3 1/4 X 13/8	1/2	13/8	15/8	1
SDS	7/16	2.187	3 1/8	7/8	3/4	0.23	25/16	2 11/16	3 1/4 X 13/8	1/2	15/8	1 15/16	1
SD	7/16	2.187	3 1/8	13/8	13/4	0.23	1 13/16	2 11/16	3 1/4 X 13/8	1/2	15/8	1 15/16	1.5
SK	9/16	2.187	3 7/8	13/8	1 1/4	0.23	1 15/16	35/16	35/16 X2	1/2	2 1/8	2 1/2	2
SF	5/8	3.125	4 5/8	1 7/16	1 1/4	0.23	2 1/16	3 7/8	3 3/8 X2	1/2	2 1/4	2 7/8	4
E	7/8	3.834	6	1 7/8	1 5/8	9/32	2 3/4	5	3 1/2 X 2 3/4	7/8	2 7/8	3 1/2	10.4
F	1	4.437	6 5/8	2 3/4	2 1/2	1 1/32	3 3/4	5 5/8	3 9/16 X 3 5/8	1	3 1/4	3 15/16	15
J	1 1/8	5.148	7 1/4	3 1/2	3 3/16	9/16	4 5/8	6 1/4	3 5/8 X 4 1/2	1 1/2	3 13/16	4 1/2	23
M	1 1/4	6.494	9	5 1/2	5 3/16	5/8	6 3/4	7 7/8	4 3/4 X 6 3/4	2	4 11/16	5 1/2	55
N	1 1/2	6.992	10	6 5/8	6 1/4	1 1/16	8 1/8	8 1/2	4 7/8 X 8	2 7/16	5 1/16	5 7/8	73
P+	1 3/4	8.242	1 13/4	7 5/8	7 1/4	3/4	9 3/8	10	4 1 X 9 1/2	2 15/16	5 13/16	7	120
W+	2	10.437	15	9 3/8	9		1 13/8	1 23/4	4-1 1/8 X 1 11/2	4	7 1/2	8 1/2	250
S+	3 1/4	12.125	1 73/4	1 21/2	12		1 53/4	15	5-X 1 1/4 X 1 5 1/2	6	8 1/4	10	400

CONSULT FACTORY

11,VASTA HOUSE,GR.FLOOR,JANMABOOMI MARG,

FORT ,MUMBAI -400001 ,INDIA.

TEL:91-22-22844307/22871995/22872449

FAX:91-22-22873597/22870770

E-mail:[info@wiperdrive.com](mailto:info@wiperdrive.com),WEB SITE:[www.wiperdrive.com](http://www.wiperdrive.com)