

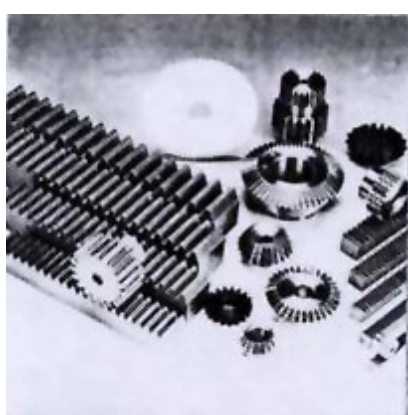

## GEAR&RACKS

### SPECIAL NOTE



The racks produced by are of the the following characters of high precision in the whole length of 2000mm,unstraight degree is within 0.20 mm ,n matter the measurement is taken at any place of the rack.

Unverticality of each vetical plane of the rack is less than 0.20mm.

Smooth finished of each side is 0.8 and over.

Error added up to circumterential pitch of any teeth is less than 0.20mm.

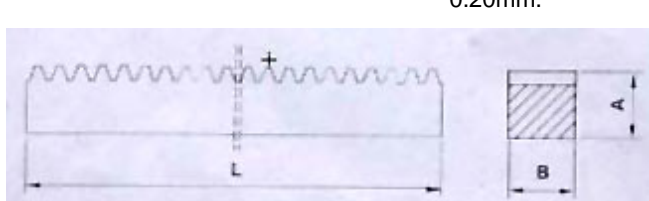

mod	C45			
	L=250	L=500	L=1000	L=2000
1	15X15	15X15	15X15	15X15
1.5	17X17	17X17	17X17	17X17
2	20X20	20X20	20X20	20X20
2.5	25X25	25X25	25X25	25X25
3	30X30	30X30	30X30	30X30
4	---	--	22X22	22X22
4	---	--	25X25	25X25
4	--	30X30	30X30	30X30
4	40X40	40 X 40	40X40	40X40
5	60X50	50 X50	50X50	50X50
6	---	60 X 60	60X60	60X60
0	---	--	40X60	80X80

	Z	MOD 1				MOD 1.5				MOD-2				MOD 2.5				
		DE	DP	DM	D1	DE	DP	DM	D1	DE	DP	DM	D1	DE	DP	DM	D1	
	12	14	12	9	6	21.0	18.0	14	8	28	24	18	10	35.0	30.0	22	10	
	13	15	13	10	6	22.5	19.5	15	8	30	26	20	10	37.5	32.5	25	10	
	14	16	14	11	6	24.0	21.0	17	8	32	28	22	10	40.0	35.0	28	10	
	15	17	15	12	6	25.5	22.5	18	8	34	30	24	10	42.5	37.5	30	10	
	16	18	16	13	6	27.0	24.0	20	8	36	32	25	10	45.0	40.0	32	12	
	17	19	17	14	6	28.5	25.5	20	8	38	34	25	10	47.5	42.5	35	12	
	18	20	18	15	8	30.0	27.0	20	8	40	36	25	10	50.0	45.0	35	12	
	19	21	19	15	8	31.5	28.5	20	8	42	38	25	10	52.5	47.5	35	12	
	20	22	20	16	8	33.0	30.0	25	8	44	40	30	10	55.0	50.0	40	12	
	21	23	21	16	8	34.5	31.5	25	10	46	42	30	12	57.5	52.5	40	14	
	22	24	22	16	8	36.0	33.0	25	10	48	44	30	12	60.0	55.0	45	14	
	23	25	23	18	8	37.0	34.5	25	10	50	46	30	12	62.5	57.5	45	14	
	24	26	24	20	10	39.0	36.0	25	10	52	48	35	12	65.0	60.0	45	14	
	TOOTH WIDTH B	25	27	25	20	10	40.5	37.5	25	10	54	50	35	12	67.5	62.5	50	14
	MODULE 1=15mm	26	28	26	20	10	42.0	39.0	30	12	56	52	40	12	70.0	65.0	50	14
	MODULE 1.5=17mm	27	29	27	20	10	43.5	40.5	30	12	58	54	40	12	72.5	67.5	50	14
	MODULE 2=20mm	28	30	28	20	10	45.0	42.0	30	12	60	56	40	12	75.0	70.0	50	14
	MODULE 2.5=25mm	29	31	29	20	10	46.5	43.5	30	12	62	58	40	14	77.5	72.5	50	14
	MODULE 3=30mm	30	32	30	20	10	48.0	45.0	30	12	64	60	40	14	80.0	75.0	55	14
	MODULE 4=40mm	31	33	31	25	10	49.5	46.5	35	12	66	62	45	14	82.5	77.5	55	16
	MODULE 5=50mm	32	34	32	25	10	51.0	48.0	35	12	68	64	45	14	85.0	80.0	55	16
	MODULE 6 = 50mm	33	35	33	25	10	52.5	49.5	35	12	70	66	45	14	87.5	82.5	55	16
	TOTAL THICKNESS A	34	36	34	25	10	54.0	51.0	35	12	72	68	45	14	90.0	85.0	55	16
	MODULE 1=25mm	35	37	35	25	10	55.5	52.5	35	12	74	70	45	14	92.5	87.5	60	16
MODULE 1.5=30mm	36	38	36	25	10	57.0	54.0	35	12	76	72	45	14	95.0	90.0	60	16	
MODULE 2=35mm	37	39	37	25	10	58.5	55.5	40	12	78	74	50	14	97.5	92.5	60	16	
MODULE 2.5=45mm	38	40	38	25	10	60.0	57.0	40	12	80	76	50	14	100.0	95.0	60	16	
MODULE 3=50mm	39	41	39	25	10	61.5	58.5	40	12	82	78	50	14	102.5	97.5	60	16	
MODULE 4=60mm	40	42	40	25	10	63.0	60.0	40	12	84	80	50	14	105.0	100.0	70	16	
MODULE 5=75mm	41	43	41	30	10	64.5	61.5	40	12	86	82	55	16	107.5	102.5	70	16	
MODULE 6 =	42	44	42	30	10	66.0	63.0	50	12	88	84	55	16	110.0	105.0	70	16	
	43	45	43	30	10	67.5	64.5	50	12	90	85	55	16	112.5	107.5	70	16	
	44	46	44	30	10	69.0	66.0	50	12	92	88	60	16	115.0	110.0	70	16	
	45	47	45	30	10	70.5	67.5	50	12	94	90	60	16	117.5	112.5	70	16	
	46	48	46	30	10	72.0	69.0	50	14	96	92	60	16	120.0	115.0	70	20	
	47	49	47	30	10	73.5	70.5	50	14	98	94	70	16	122.5	117.5	80	20	
	48	50	48	30	10	75.0	72.0	50	14	100	96	70	16	125.0	120.0	80	20	
	49	51	49	30	10	76.5	73.5	50	14	102	98	70	16	127.5	122.5	80	20	
	50	52	50	30	12	78.0	75.0	50	14	104	100	70	16	130.0	125.0	80	20	
	51	53	51	40	12	79.5	76.5	60	14	106	102	70	16	132.5	127.5	80	20	
	52	54	52	40	12	81.0	78.0	60	14	108	104	70	16	135.0	130.0	90	20	
	53	55	53	40	12	82.5	79.5	60	14	110	106	70	16	137.5	132.0	90	20	
	54	56	54	40	12	84.0	81.0	60	14	112	108	70	16	140.0	135.0	90	20	
	55	57	55	40	12	85.5	82.5	60	16	114	110	70	16	142.5	137.5	90	20	
	56	58	56	40	12	87.0	84.0	60	16	116	112	70	16	145.0	140.0	100	20	
	57	59	57	40	12	88.5	85.5	60	16	118	114	70	16	147.5	142.5	100	20	
	58	60	58	40	12	90.0	87.0	60	16	120	116	70	16	150.0	145.0	100	20	
	59	61	59	40	12	91.5	88.5	60	16	122	118	70	16	152.5	147.5	100	20	
	60	62	60	40	12	93.0	90.0	60	16	124	120	70	16	155.0	150.0	100	20	
	61	63	61	50	12	94.5	91.5	70	16	126	122	80	16					
	62	64	62	50	12	96.0	93.0	70	16	128	124	80	16					
	63	65	63	50	12	97.5	94.5	70	16	130	126	80	16					
	64	66	64	50	12	99.0	95.0	70	16	132	128	80	16	167.5	162.5		20	
	65	67	65	50	12	100.5	97.5	70	16	134	130	80	16					
	66	68	66	50	12	102.0	99.0	70	16	136	132	80	16					
	67	69	67	50	12	103.5	100.5	70	16	138	134	80	16					
	68	70	68	50	12	105.0	102.0	70	16	140	136	80	16					
	69	71	69	50	12	106.5	103.5	70	16	142	138	80	16					
	70	72	70	50	12	108.0	105.0	70	16	144	140	80	16	180.0	175.5		20	
	72	74	72		12	111.0	108.0		16	148	144		16	185.0	180.0		20	
	75	77	75		12	115.5	112.5		16	154	150		20	192.5	187.0		20	
	76	78	76		12	117.0	114.0		16	156	152		20	195.0	190.5		20	
	80	82	80		12	123.0	120.0		16	164	160		20	205.0	200.0		25	
	85	87	85		12	130.5	127.5		16	174	170		20	217.5	212.5		25	
	90	92	90		12	138.0	135.0		16	184	180		20	230.0	225.0		25	

**TYPE -B 1:3.5**

M	Z	DE	DP	H	F	D	D	V	L	LM	S
1.5	16	28.1	24	24	12	20.3	8	30.0		11.5	
	56	84.5	84	34.8	12	45.3	14	8.2	32	25	2.8
2	16	37.5	32	30.9	16	25.3	8	40.1		14.1	
	56	112.6	12	37.1	16	55.3	16	10.9	33.3	25	3.8
2.5	16	46.8	40	38.9	20	32.3	14	50.1		17.9	
	56	140.8	140	44.4	20	60.3	20	13.6	40	30	4.4
3	16	56.2	48	49.9	24	40.3	16	60.3		24.9	
	56	169.0	168	52.7	24	80.3	25	16.3	47.5	35	5.2
3.5	16	65.6	56	52.	25	25.5	20	73.0		25.5	
	56	197.1	196	55.1	25	80.3	25	19.9	49.1	35	6

+

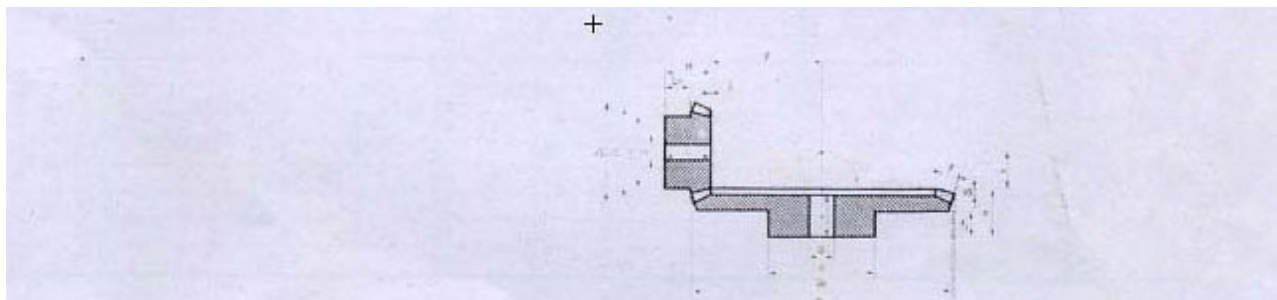

**TYPE B (1:4)**

M	Z	DE	DP	H	F	d	D	V	L	LM	S
1.5	15	26.70	22.5	23	11	20.3	8	34.0		11.7	
	60	90.40	90.0	34	11	50.3	16	8.0	31.2	25	2.8
2	15	35.60	30.0	31	16	25.3	8	44.0		14.4	
	60	120.60	120.0	37.6	16	60.3	16	10.4	34.2	25	3.4
2.5	15	44.50	37.5	38.1	19	32.3	14	55.9		18.4	
	60	150.70	150.0	44.8	19	60.3	20	13.2	40	30	4.8
3	15	53.30	45.0	48.1	23	40.3	16	66.9		24.5	
	60	180.80	180.0	53.2	23	80.3	25	15.8	48.2	35	5
3.5	15	62.20	52.5	52.1	26	45.3	20	78.9		25.1	
	60	211.00	210	60.4	26	90.3	30	18.6	54.4	40	6
4	15	71.10	60.0	55.1	30	50.3	20	89.9		23	
	60	241.10	240.0	60.8	30	90.3	30	21.2	53	40	7.8
4.5	15	79.97	67.5	57	32	52.3	20	102.9		23	
	60	271.24	270.0	62	32	90.3	30	24.3	53.5	40	8.5
5	15	88.80	75.0	62	34	55.3	20	115.7		25	
	60	301.30	300.0	65	34	90.3	30	27.0	55	40	10

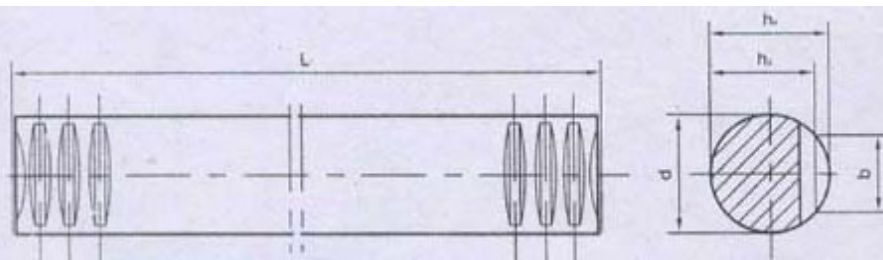

**STRAIGHT TOOTH SYSTEM**

MODULE	L1	Ø d n 1t	b	hk	ho	kg
1	251.3	15	7.5	15	14.0	0.34
	0.6641.3599.5	15	7.5	15	14.0	0.66
	999.0	15	7.5	15	14.0	1.35
1.5	249.8	17	9.6	17	15.5	0.42
	499.5	17	9.6	17	15.5	0.48
	999.0	17	9.6	17	15.5	1.70
2	251.3	20	12.0	20	18.0	0.55
	502.7	20	12.0	20	18.0	1.10
	999.0	20	12.0	20	18.0	2.20
2.5	251.3	25	15.0	25	22.5	0.90
	502.7	25	15.0	25	22.5	1.80
	999.0	25	15.0	25	22.5	3.60
3	254.5	30	18.0	30	27.0	1.30
	499.5	30	18.0	30	27.0	2.50
	999.0	30	18.0	30	27.0	5.10
4	251.3	40	24.0	40	36.0	2.30
	50.26	40	24.0	40	36.0	4.50
	1005.3	40	24.0	40	36.0	9.10
5	251.3	50	30.0	50	45.0	3.80
	50.26	50	30.0	50	45.0	7.10
	1005.3	50	30.0	50	45.0	14.30

**Special notice**

Material C 45k. Mat No. 1.0503, of specially treated bright steel  
 Øn11 with a tensile strength of approx. 650 N/mm<sup>2</sup>. Both ends of  
 the racks are designed so that several racks can be linked to obtain any  
 desire length. Please see also our guide pages on page E-16

**11, VASTA HOUSE, GR. FLOOR, JANMABOOMI MARG,  
 FORT, MUMBAI - 400001, INDIA.**

**TEL: 91-22-22844307/22871995/22872449**

**FAX: 91-22-22873597/22870770**

**E-mail: [info@wiperdrive.com](mailto:info@wiperdrive.com), WEB SITE: [www.wiperdrive.com](http://www.wiperdrive.com)**