

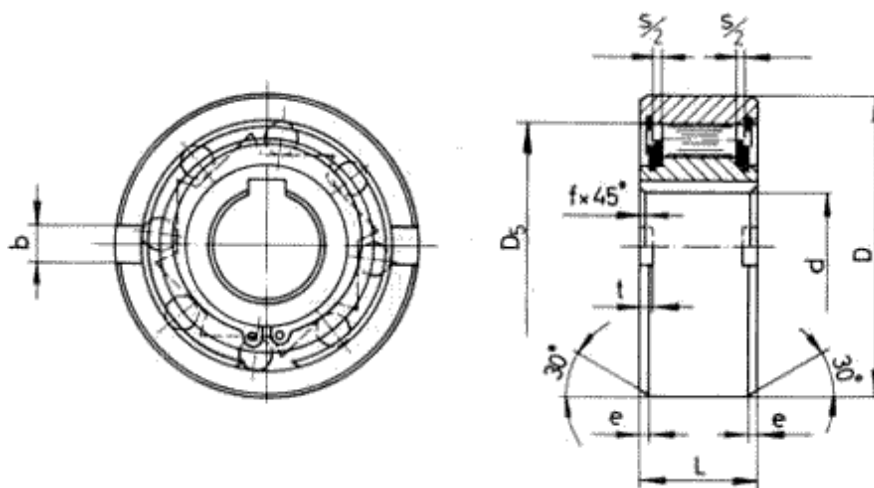

PSN TYPE



SIZE dH7 mm	NOMINAL TORQUE ¹ Tn Nm	OVERRUNNING SPEED ²		Dn6 mm	Lmm	Ds mm	FACE GROOVE					WEIGHT kg
		max INNERRACE RPM	max OUTERRACE RPM				b mm	t mm	s mm	emmm	t mm	
12	7	3300	5000	35	13	28	4	1.2	1.2	0.6	0.3	0.06
15	19	2400	3600	42	18	37	5	1.2	1.2	0.8	0.3	0.11
17	28	2300	3400	47	19	40	5	2.0	1.2	0.8	0.8	0.15
20	44	2100	3100	52	21	42	6	1.8	1.8	0.8	0.8	0.20
25	75	1700	2600	62	24	51	8	2.0	2.4	1	0.8	0.40
30	150	1400	2200	72	27	60	10	2.5	0.6	1.8	1	0.55
35	230	1200	1900	80	31	70	12	3.5	0.6	1.8	1	0.80
40	320	1100	1700	90	33	78	12	3.5	1.2	1.8	1	0.95
45	460	1000	1600	100	36	85	14	3.5	2.4	1.8	1	1.40
50	600	850	1350	110	40	92	14	4.5	1.2	1.8	1	1.80
60	1060	750	1050	130	46	110	18	5.5	1.2	2.6	1.5	2.80
70	1360	600	950	150	51	125	20	6.5	2.2	2.6	1.5	4.20
80	2000	550	850	170	58	140	20	7.5	1.2	2.6	1.5	6.10
90	2550	500	750	190	64	160	20	8.0	2.4	2.6	2	8.2
100	4100	450	680	215	73	175	24	8.5	2.4	2.6	2	12.6
120	6950	370	550	260	86	215	28	10	3.2	3	2.5	22
150	14300	300	460	320	108	260	32	12	3.2	3	2.5	42

KEYWAYS:

PSN 12.PSN 150 TO DIN 6885 PAGE 1,OTHER SIZE PAGE 3

1)T MAX IS 2.5 x NOMINAL TORQUE (Tn)FOR SHORT PERIODS ONLY.

2)THE INDICATED MAXIMUM OVERRUNNING (IDLING) SPEED ARE VALID FOR PRESSURE LUBRICATION ONLY.FOR OIL BATH LUBRICATION 65% OF INDICATED SPEEDS. IF HIGHER SPEEDS ARE REQUIRED OTHER THAN THOSE LISTED PLEASE CONSULT

THE ASSAMBLY DIMENSIONS OF CLUTCHES PS ARE IDENTICAL TO THOSE OF BALL-BEARING SIZES SERIES 62. DRIVE TO THE INNER RACE IS TRANSMITTED BY A KEY WAY AND TO THE OUTER RACE BY A PRESS FIT. WE RECOMMEND THE FOLLOWING LIMITS:

SHAFT Dn6 OR j6 BORE DH7 OR J7

THIS TYPE OF FREEWHEEL DONOT HAVE THE BEARINGS,HENCE THE OUTER AND INNER RACES MUST BE PRECISELY CENTERED AND ALIGNED WITH RESPECT TO EACH OTHER BY PROVIDING EXTERNAL BEARING SUPPORT.

WHILE INSTALLING ,A CARE SHOULD BE TAKEN THAT THERE IS NO RELATIVE AXIAL TORCE BETWEEN INNER AND OUTER RACES OF FREEWHEEL.PRESS IN AND REMOVAL OF INNER AND OUTER RACE SHOULD BE DONE SIMULTANEOUSLY.

FOR INDEXING APPLICATIONS. FREEWHEEL CAN BE SUPPLIED WITH STRONGER 'V' OR 'VV' SPRINGS.THE BEST INDEXING ACCURACY IS REACHED BY USING LUBRICATING OILS WITH A LOW VISCOSITY OF ABOUT 12 mm²/sec AT OPERATING TEMPERATURE.

11,VASTA HOUSE,GR.FLOOR,JANMABOOMI MARG,
FORT ,MUMBAI-400001 ,INDIA.

TEL:91-22-22844307/22871995/22872449

FAX:91-22-22873597/22870770

E-mail:info@wiperdrive.com,WEB SITE:www.wiperdrive.com