

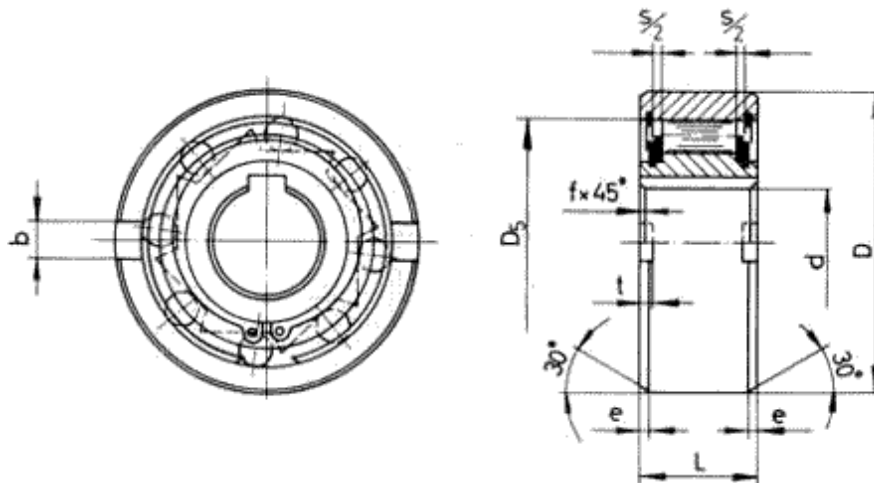

## PE TYPE



SIZE dh7 mm	NOMINAL TORQUE <sup>1</sup> Tn Nm	OVERRUNNING SPEED <sup>2</sup>		Dn6 mm	D5mm	D6 mm	Lmm	smm	fmm	e mm	FACE GROOVE		WEIGHT kg
		max INNERRACE RPM	max OUTERRACE RPM								b mm	t mm	
12	9.5	3100	6200	37	28	20	20	3	0.5	0.5	6	3	0.11
15	30	2300	5600	47	37	26	30	3	0.8	0.8	7	3.5	0.30
20	85	2000	4800	62	50	35	34	3	0.8	0.8	8	3.5	0.55
25	124	1700	400	80	68	45	37	4	1	1	9	4	0.98
30	230	1500	3400	90	75	50	44	4	1	1	12	5	1.50
35	290	1300	2800	100	80	55	48	4	1	1	13	6	2.00
40	490	1200	2500	110	90	60	56	4	1.5	1.5	15	7	2.80
45	670	1050	2200	120	95	65	56	4	1.5	1.5	16	7	3.30
50	1100	950	2050	130	110	78	63	4	1.5	1.5	17	8	4.20
55	1250	850	1950	140	115	82	67	2	2	2	18	9	5.20
60	1800	800	1800	150	125	90	78	6	2	2	18	9	6.80
70	2650	650	1700	170	140	100	95	10	2.5	2.5	20	9	10.5
80	4000	500	1500	190	160	115	100	14	2.5	2.5	20	9	14.9
90	7500	400	1300	215	180	130	115	13	3	3	24	11	21.1
100	9500	350	1150	260	210	150	120	7	3	3	28	13	33.6
120	13900	230	900	300	240	180	140	10	4	4	32	18	51.5
150	27000	160	600	370	310	230	180	16	4	4	32	18	96.2
200	70000	125	460	480	400	300	240	16	5	5	40	25	230

KEYWAYS: TO DIN 6885 PAGE 1

1) T MAX IS 2.5 x NOMINAL TORQUE (Tn) FOR SHORT PERIODS ONLY.

2) THE INDICATED MAXIMUM OVERRUNNING (IDLING) SPEED ARE VALID FOR PRESSURE LUBRICATION ONLY. FOR OIL BATH LUBRICATION 65% OF INDICATED SPEEDS. IF HIGHER SPEEDS ARE REQUIRED OTHER THAN THOSE LISTED PLEASE CONSULT

THE ASSAMBLY DIMENSIONS OF CLUTCHES PS ARE IDENTICAL TO THOSE OF BALL-BEARING SIZES SERIES 62. DRIVE TO THE INNER RACE IS TRANSMITTED BY A KEY WAY AND TO THE OUTER RACE BY A PRESS FIT. WE RECOMMEND THE FOLLOWING LIMITS:

SHAFT Dn6 OR j6 BORE DH7 OR J7

THIS TYPE OF FREEWHEEL DONOT HAVE THE BEARINGS, HENCE THE OUTER AND INNER RACES MUST BE PRECISELY CENTERED AND ALIGNED WITH RESPECT TO EACH OTHER BY PROVIDING EXTERNAL BEARING SUPPORT.

WHILE INSTALLING , A CARE SHOULD BE TAKEN THAT THERE IS NO RELATIVE AXIAL TORCE BETWEEN INNER AND OUTER RACES OF FREEWHEEL. PRESS IN AND REMOVAL OF INNER AND OUTER RACE SHOULD BE DONE SIMULTANEOUSLY.

FOR INDEXING APPLICATIONS. FREEWHEEL CAN BE SUPPLIED WITH STRONGER 'V' OR 'VV' SPRINGS. THE BEST INDEXING ACCURACY IS REACHED BY USING LUBRICATING OILS WITH A LOW VISCOSITY OF ABOUT 12 mm<sup>2</sup>/sec AT OPERATING TEMPERATURE.

11, VASTA HOUSE, GR. FLOOR, JANMABOOMI MARG,  
FORT , MUMBAI - 400001 , INDIA.

TEL: 91-22-22844307/22871995/22872449

FAX: 91-22-22873597/22870770

E-mail: [info@wiperdrive.com](mailto:info@wiperdrive.com), WEB SITE: [www.wiperdrive.com](http://www.wiperdrive.com)