

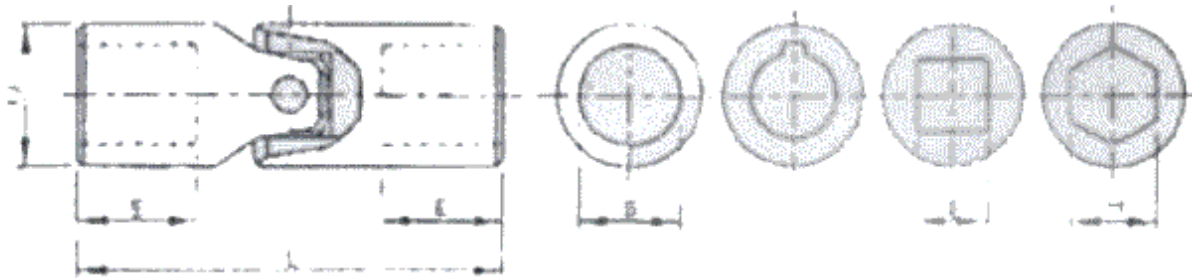

SINGLE UNIVERSAL JOINTS-TYPES MA AND ME

THESE JOINTS ARE FOR USE ON SHAFTS WITH SPEED UP TO 800 SEC/MIN AND WORKING ANGLE UPTO 25° (powered)
OF 35° (sand operated)



CODE	SIZE	L	E MIN	D	STANDARD SIZE	'B' MAX				STAITC BREZING TORQUE (Nm)	L	E MAX	SIZE	CODE	
						ROUND	WITH Kway	S SQUARE	H MAX						
940A-----	MA10	38	12												
B--	MA13	45	13	10	6	6	-	-	-	13.5	44	15	ME10	944A--	
C	MA16	52	15	13	6	8	-	-	-	20	50	16	ME13	B	
D	MA20	62	16	16	8	10	8	-	-	45	56	19	ME16	C	
E	MA25	74	20	20	10	13	11	10	10	60	84	19	ME20	D	
F	MA23	85	25	25	12	16	14	12	12	180	98	26	ME25	E	
G	MA40	108	30	32	16	22	16	16	16	405	99	28	ME32	F	
H	MA45	120	32	40	20	25	22	19	19	860	108	30	ME40	G	
J	MA50	132	37	45	20	30	25	22	22	1250	127	36	ME45	H	
K	MA60	155	46	50	25	35	30	25	25	1790	140	41	ME50	J	
L	MA73	190	53	63	32	45	35	32	32	3400	172	52	ME63	K	
				75	40	55	45	40	40	5300	222	69	ME75	L	

11, VASTA HOUSE, GR. FLOOR, JANMABOOMI MARG,
FORT, MUMBAI-400001, INDIA.

TEL: 91-22-22844307/22871995/22872449

FAX: 91-22-22873597/22870770

E-mail: info@wiperdrive.com, WEB SITE: www.wiperdrive.com